

1 Block D - Section A-A  
1 : 200

Block D Section

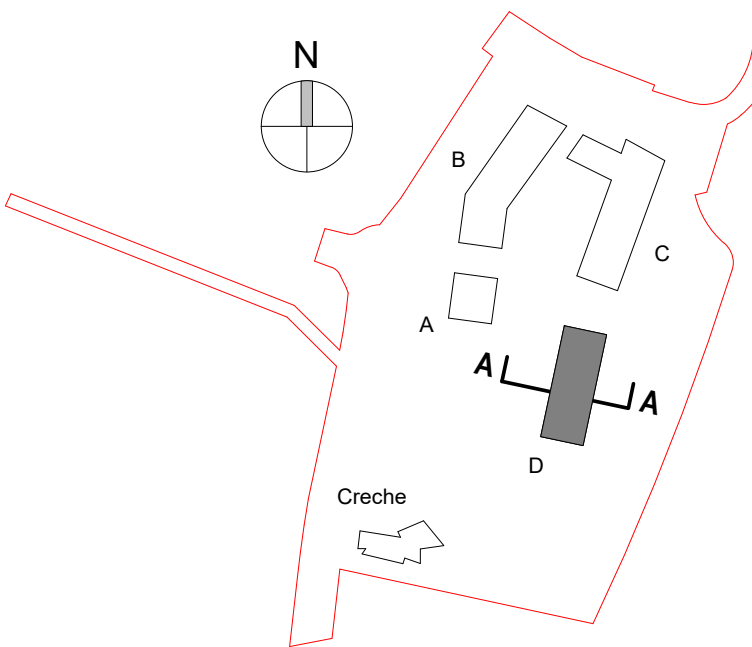

Revision Description	Date	Rev. No.	Issued by
Issued for Planning	10.12.2021	C01	ES
Figured dimensions only to be used. This drawing is copyright of O'Mahony Pike Architects Ltd. All information is shared as per approved use in accordance with ISO19650-2:2018, Table 5; Standard Codes for Suitability of Models and Documents and the BEP. If the 'Status' field is empty, this information has been shared at SO - WIP.			

<b>o'mahony pike</b>			<b>Project Code:</b> 19072C	<b>Scale @ A1:</b> 1 : 200
<b>architecture   urban design</b> email: info@omahonypike.com tel: +353 1 202 7400 fax: +353 1 283 0822 www.omahonypike.com			<b>Project Lead:</b> JS	<b>Date:</b> 10.12.2021
			<b>Drawn By:</b> ES	<b>Revision:</b> C01
			<b>Job No.:</b> 19072C	<b>Status:</b> A3
			<b>Purpose:</b> Planning	
<b>Project:</b>	Lands at Hollystown-Kilmartin			
<b>Location:</b>	Kilmartin Local Centre, Hollywoodrath, Dublin 15			
<b>Client:</b>	Glenveagh Homes Ltd.			
<b>Drawing Title:</b>	Block D Section			
<b>Drawing No.:</b>	19072C-OMP-BD-ZZ-DR-A-3000			